

Connecting a AV device

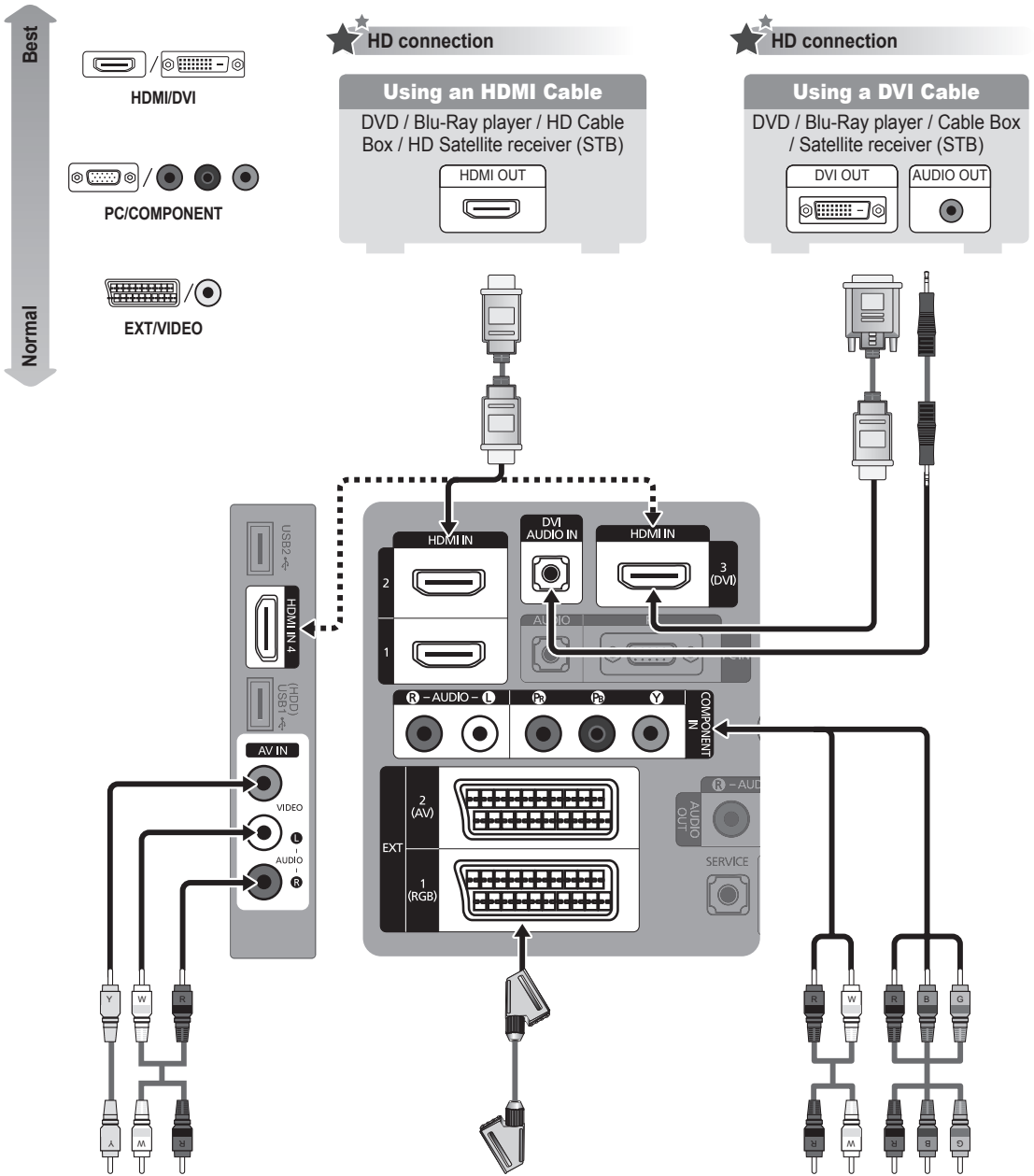

★ ★ HD connection

Using an HDMI Cable

DVD / Blu-Ray player / HD Cable Box / HD Satellite receiver (STB)

HDMI OUT

★ ★ HD connection

Using a DVI Cable

DVD / Blu-Ray player / Cable Box / Satellite receiver (STB)

DVI OUT

AUDIO OUT

Audio/Video connection

Using an Audio/Video Cable

VCR

VIDEO OUT

AUDIO OUT

Using a Scart Cable

VCR / DVD

EXT

Component connection

Using a Component Cable

DVD / Blu-Ray player / Cable Box / Satellite receiver

AUDIO OUT

COMPONENT OUT

LCD TV

QUICK SETUP GUIDE

The Supplied Accessories



Remote Control & Batteries (AAA x 2)



Power Cord



Programme CD



Cleaning Cloth

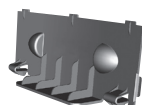

Cover-Bottom



Holder-Wire Cable
(Depending on the model)

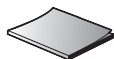

User Manual

Installing Batteries in the Remote Control

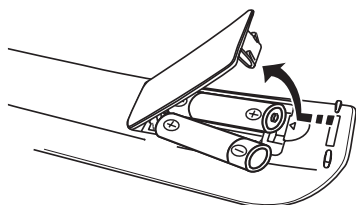

BN68-01902F-01

Installing the Stand

Preset

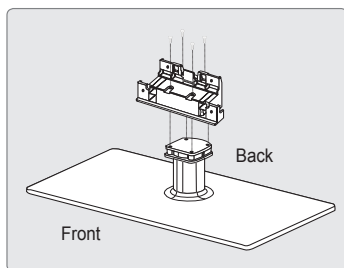

Step 1

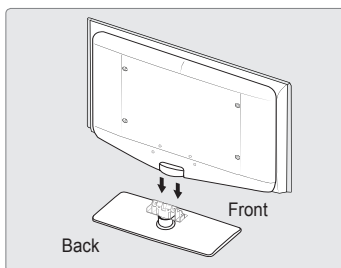

Step 2

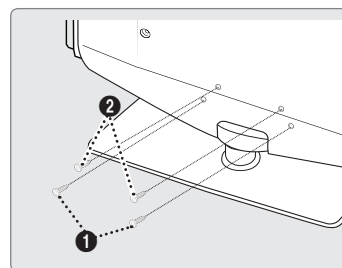

Preset: Place the Guide Stand and Cover Neck onto the stand and fasten it using the screws.

Step 1. Attach your LCD TV to the stand.

- Two or more people should carry the TV.
- Make sure to distinguish between the front and back of the stand when assembling them.
- To make sure the TV is installed on the stand at a proper level, do not apply excess downward pressure to the upper left or right sides of the TV.

Step 2. Fasten two screws at position 1 and then fasten two screw at position 2.

- Stand the product up and fasten the screws. If you fasten the screws with the LCD TV placed down, it may lean to one side.

Assembling the Cables

Enclose the cables in the Holder-Wire Cable so that the cables are not visible through the transparent stand.

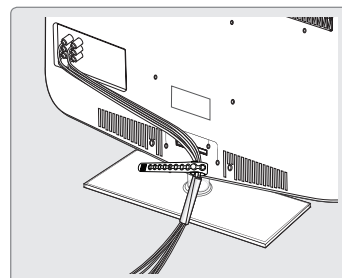

Using the remote control buttons

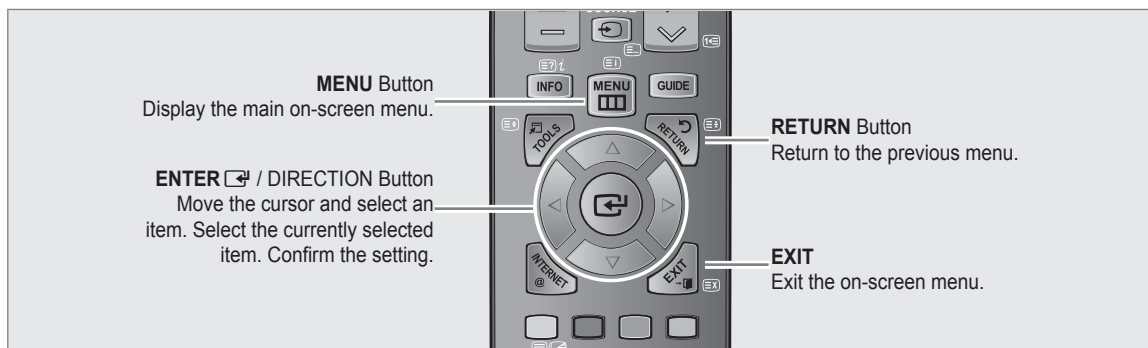

Plug & Play

When the TV is initially powered on, basic settings proceed automatically and subsequently. If you want to reset this feature, press the **MENU** button to display menu. You can set the Plug & Play by selecting 'Setup → Plug & Play'.

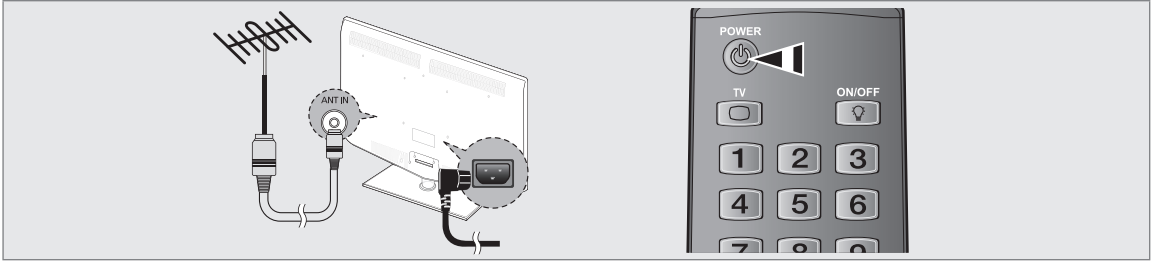

On the screen, you can set as follows.
 The each step may vary depending on the Antenna source.

